



# COOLER DESIGN, Inc.



**Maegen R. Fleck**  
Architectural Designer

## Education

University of Kansas:  
Bachelor of Arts in  
Architectural Studies with  
minor in Design, 2005

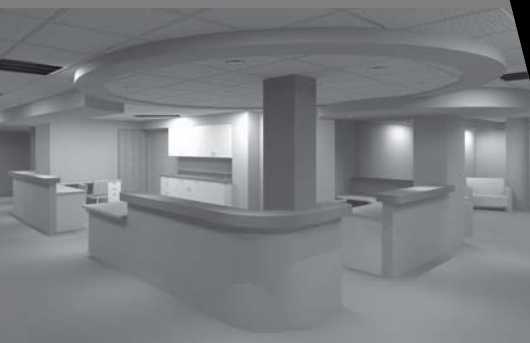

## Professional Background

Maegen earned her degree in architecture at the University of Kansas where she also minored in design. After graduating in 2005, she went on to work with several architectural firms in Indianapolis where she built on her educational experiences by working on commercial, residential and institutional projects throughout the Midwest region. Maegen began her career at a small architecture firm where she helped design commercial and religious buildings. From there she moved to a larger firm that specialized in educational and athletic facilities for townships and school districts within Indiana. In 2007 Maegen joined Cooler Design, Inc. where she focuses on the design of healthcare facilities. Her athletic background has been valuable on the firm's rehabilitation projects. Maegen also has an extensive knowledge of codes and is proficient in the Building Information (BIM) software, Revit.

## Related Project Experience

**Spine Center, IU Health Bloomington Hospital;** Bloomington, IN — \$5,400,000; This project consists of a new 12,111 sq. ft. free-standing medical office building to accommodate a new Spine Center which will provide a diagnostic Magnetic Resonance Imaging suite, a physical therapy suite, and pain management & treatment center. The mechanical system features a geothermal HVAC system which will also be used to cool the magnet for the MRI. Construction is anticipated to start in 2012.

**Bloomington Hospital of Orange County Renovation and Addition;** Paoli, IN — This \$4m project included reworking the interior and exterior of the hospital to give it a bold new look and to add a new covered canopy and public lobby. This addition will free up space within the hospital to increase the size of the completely renovated and enlarged emergency department; but will require the cafeteria and registration areas to be relocated.

**IU Health West Hospital Cardiac Rehabilitation;** Avon, IN — The project consisted of the build-out of 3,642 SF of space located in the garden level of the existing Medical Center to accommodate an expansion of the existing Physical Therapy and Occupational Therapy. This new space is across the corridor from the existing suite and serves to expand the services provided and add Cardiac Rehabilitation and therapy education services.